

End Suction Centrifugal Pump Single Stage Back Pull-Out



BP SERIES

APPLICATIONS

- * Air Conditioning
- * Fire Protection
- * Circulating
- * Irrigation
- * Pressure Boosting
- * Water Treatment & Supply
- * Refrigeration
- * Plumbing
- * Liquid Transfer
- * Drainage
- * De-watering
- * Cooling Towers
- * Water Heating

End Suction Centrifugal Pump

BP SERIES

PUMP KEY

BP 65 / 32 H

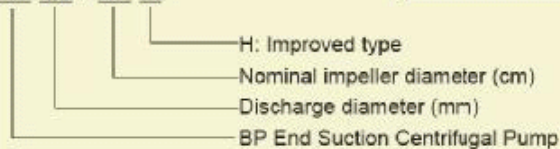

MATERIALS OF CONSTRUCTION		
Pump Parts	All Iron (AI)	Bronze Fitted (BF)
Casing	Cast Iron	Cast Iron
Impeller	Cast Iron	Bronze
Wear Ring	Cast Iron	Bronze
Shaft	S. Steel	S. Steel
Shaft Sleeve	S. Steel	S. Steel
Gland	Cast Iron	Cast Iron



TECHNICAL INFORMATION

- * Design : DIN 24255
- * Operating pressure : 1000kPa standard; 1600kPa optional
- * Hydrostatic test pressure : 1500kPa standard; 2400kPa optional
- * Operating temperature : -10- C to +105- C standard; 160- C optional
- * Operating speed : 50 Hz, 1450rpm and 2900 rpm; 60 Hz, 1750rpm and 3500 rpm

FEATURE OF CONSTRUCTION

- * The **BP** Series Pumps meet the DIN 24255 specification for end suction, horizontal centrifugal pumps. The **BP** Series offers many features and benefits that improve performance, increase reliability and reduce maintenance time and cost.
- * Heavy-duty cast iron casing with integral cast feet suitable for 10 bar working pressure. Working pressures up to 16 bar also available. Centerline discharge assures that the casing is self-venting.
- * Flanges to ISO 2084 PN16 as standard. Also available with ASA 125# or JIS 10k drilling.
- * Back pull out design for fast and easy maintenance when fitted with a spacer type coupling because suction and discharge piping and drive motor remain in place.
- * Maximum interchangeability for low spare parts inventory with 4 bearing housings and 4 shaft sizes for 47 sizes of pumps.
- * Replaceable wear rings to assure optimum efficiency and performance at all times.
- * Shaft seal is available as packing or as mechanical seal to suit all types of applications.
- * Double shrouded, hydraulically balanced impellers with back vanes to minimize gland pressure in cast iron or bronze as standard. Also available in stainless steel or zincfree bronze.
- * Heavy-duty cast iron bearing housing with SKF greased ball bearings as standard. Also available with oil lubricated bearings.
- * Heavy-duty shaft in stainless steel for longer life and to assure product purity.
- * Stainless steel shaft sleeve for product purity, longer mechanical seal life and to prevent damage to the shaft from packing or mechanical seal.
- * Operating temperature from -10- C to +105- C as standard. Available for up to +160- C with cooling and suitable mechanical seal selection.
- * Suitable for both 50 cycle and 60 cycle speeds up to 3600rpm.

End Suction Centrifugal Pump

OVERALL DIMENSION

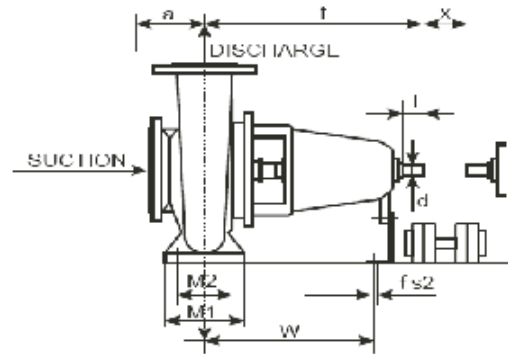
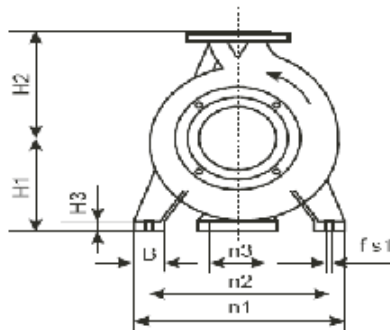

Unit: in mm

Model	Shaft Diameter	Inlet	Outlet	Pump Dimensions								Foot Dimensions								Shaft End	Coupling Key	Weight (Kg)				
				a	r	H1	H2	B	M1	M2	n ₁	n ₂	n ₃	H3	fs ₁	fs ₂	W	x	d				l			
BP 32-13	25	50	32	80		112	140	50	100	70	190	140	100												28	
BP 32-16				80	360	132	160	50	100	70	240	190	100	14	14	14	267	140	24	50	8X7	36				
BP 32-20				80		160	180	50	100	70	240	190	110													43
BP 32-26				100		180	225	65	125	95	320	250	110													63
BP 40-13	25	65	40	80	360	112	140	50	100	70	210	160	100				267		24	50	8X7	31				
BP 40-16				80	360	132	160	50	100	70	240	190	100				267		24	50	8X7	37				
BP 40-20				100	360	160	180	50	100	70	265	212	110	14	14	14	267	140	24	50	8X7	46				
BP 40-25				100	360	180	225	65	125	95	320	250	110				267		24	50	8X7	53				
BP 40-32	35			125	470	200	250	65	125	95	350	280	110			342		32	80	10X8	96					
BP40/32H				45H	125	519	200	250	65	125	95	350	280	110			362		42	110	12X8	104				
BP 50-13	25	65	50	100	360	132	160	50	100	70	240	190		14		267		24	50	8X7	34					
BP 50-16				100	360	160	180	50	100	70	265	212		14		267		24	50	8X7	38					
BP 50-20				100	360	160	200	50	100	70	265	212	110	14	14	14	267	140	24	50	8X7	48				
BP 50-26				100	360	180	225	65	125	95	320	250		14			267		24	50	8X7	65				
BP 50-32	35			125	470	225	280	65	125	95	350	280		16		342		32	80	10X8	101					
BP50-32H				45H	125	523.5	225	280	65	125	95	350	280		16		364		42	110	12X8	110				
BP 65-13	25	80	65	100	360	160	180	65	125	95	280	212		14	14	267		24	50	8X7	40					
BP 65-16				100	360	150	200	65	125	95	280	212		14	14	267		24	50	8X7	44					
BP 65-20				100	360	180	225	65	125	95	320	250		14	14	267		24	50	8X7	54					
BP 65-26				100	470	200	250	80	160	120	360	280	110	16	16	14	342	140	32	80	10X8	83				
BP 65-32	35			125	470	225	280	80	160	120	400	315		16	16	342		32	80	10X8	110					
BP65-32H				45H	125	520	225	280	80	160	120	400	315		16	16	363		42	110	12X8	118				
BP 80-16	35	100	80	125	360	180	225	65	125	95	320	250		14	14	267		24	50	8X7	55					
BP 80-20				125	470	180	250	65	125	95	345	280		14	14	342		32	80	10X8	72					
BP 80-26				125	470	200	280	80	160	120	400	315	110	16	16	14	342	140	32	80	10X8	92				
BP 80-32				125	470	250	315	80	160	120	400	315		16	16		342		32	80	10X8	120				
BP80-32H	45H			521	250	315	80	160	120	440	355		16	16	363		42	110	12X8	128						
BP 80-40				45	530	280	355	80	160	120	440	355		18	18		370		42	110	12X8	162				
BP100-16	35	125	100	125	470	200	250	80	160	120	360	280		16	16	342		32	80	10X8	81					
BP100-20				125	470	200	280	80	160	120	360	280		16	16	342		32	80	10X8	87					
BP100-26				140	470	225	280	80	160	120	400	315		16	16		342		32	80	10X8	110				
BP100-26H				45H	140	520	225	280	80	160	120	400	315	110	16	16	14	363	140	42	110	12X8	117			
BP100-32	45H			140	470	250	315	80	160	120	400	315		16	16	342		32	80	10X8	134					
BP100-32H				140	520	250	315	80	160	120	400	315		16	16		363		42	110	12X8	143				
BP100-40				140	530	280	355	100	200	150	500	400		18	23		370		42	110	12X8	177				
BP125-20				35	150	125	140	470	250	315	80	160	120	400	315		16	16	342		32	80	10X8	111		
BP125-26	140	470	250				355	80	160	120	400	315		16	16	14	342	140	32	80	10X8	115				
BP125-32	140	530	280				355	100	200	150	500	400		18	23		370		42	110	12X8	163				
BP125-40	140	530	315				400	100	200	150	500	400		18	23		370		42	110	12X8	190				
BP150-20	45	200	150	160	495	280	400				550	450		20		367		32	80	10X8	140					
BP150-26				160	530	250	355				550	350		18	23	14	370	140	42	110	12X8	164				
BP150-32				160	530	280	400	100	200	150	550	450	110	18	23		370		42	110	12X8	175				
BP150-40				160	530	315	450				550	450		18	23		370		42	110	12X8	210				
BP200-32	55	250	200	225	725	315	435	100	200	150	550	450	140			500		48		14X10	251					
BP200-40				225	670	315	450	100	200	150	550	450	140			500		48		14X10	295					
BP250-32				250	693	400	600	100	270	180	600	400	180	30	23	14	513	140	48	110	14X10	311				
BP250-40				250	797	450	505	125	270	210	600	500	180				611		60		18X12	390				

End Suction Centrifugal Pump Single Stage Back Pull-Out

SELECTION CHART

2900RPM

- Module 25
- Module 45
- Module 35
- Module 55

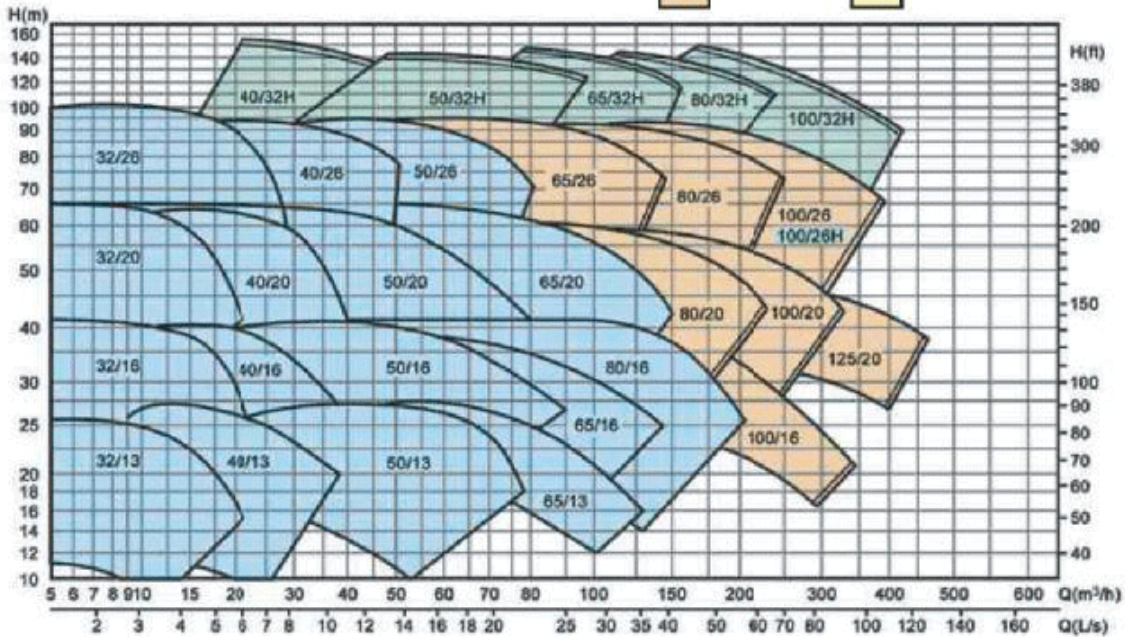

1450 RPM

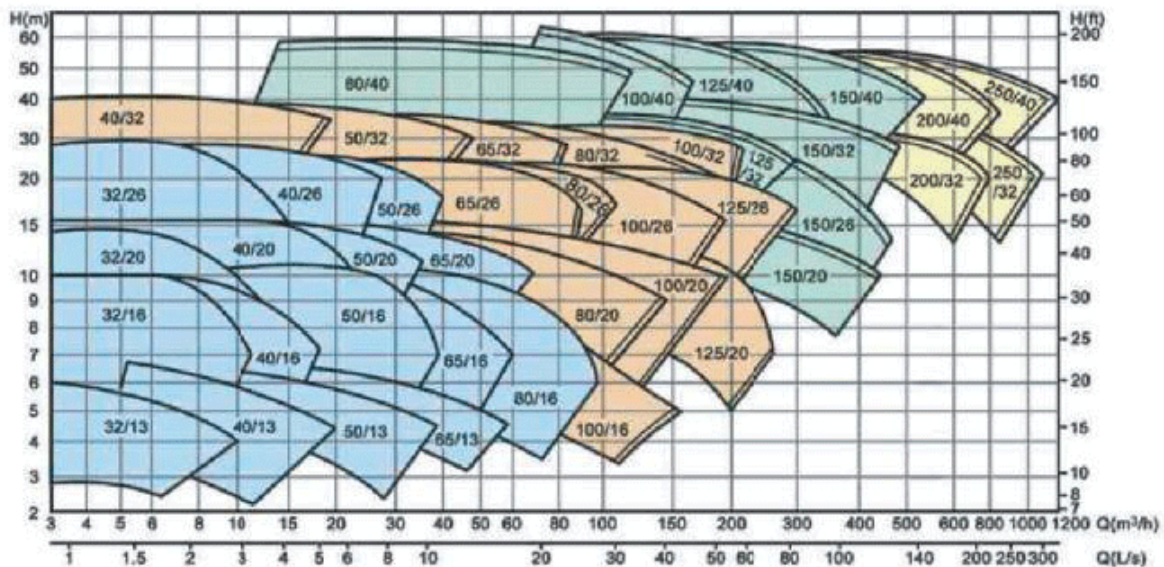

Performance curve of each model are available on request. The information is subject to change without prior notice.